

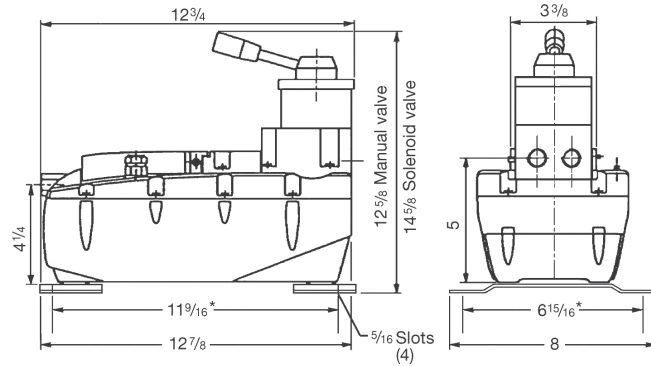

**Air/oil power unit
for use with hydraulic rollblocks
max. operating pressure 5,800 psi**



* Bolt pattern for mounting screws

Application:

This pump series is for use with high pressure die lifters (page 8.1834A).

Description:

The die lifter pumps include a circuit relief valve which eliminates pressure intensification by overloaded die lifters.

The clamp system pumps include pressure switches to monitor clamping circuits for machine safety.

Advantages:

- ◆ compact design
- ◆ horizontal mounting

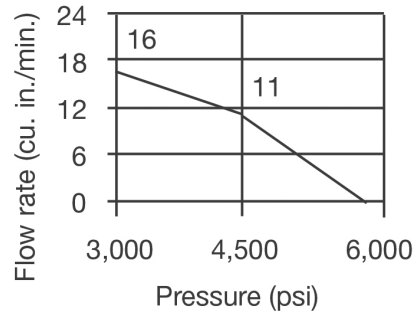

Operating pressure	psi	3,000-5,800
Inlet air pressure	psi	60
Flow rate	(cu in/min)	see graph
Usable fluid capacity	(cu in)	125
Connecting threads		
• Oil ports		G 1/4 BSPP
• Air inlet		1/4 NPT
Weight	(lbs)	14

Part No.	Application	Directional Valve	Circuit Relief Valve	Pressure Switch
HCR-PA-41201	High pressure die lifters	1 manual, 3 pos., 4 way	1	None
HCR-PA-41501	High pressure die lifters	1 110 VAC solenoid 2 pos., 3 way	1	None